



SHARKY
FILES AND TOOLS



SHARKY
FILES AND TOOLS

河北小鲨工具有限公司

HEBEI SHARKY FILES AND TOOLS CO., LTD

地址：河北省邢台市南和县果四村198号
No. 198 Guosi Nanhe, Xingtai City, Hebei, China
TEL : +86 157 1329 5989
+86 319 4668989
FAX : +86 319 4669044
EMAIL : sales@sharkytools.com
<http://www.sharkytools.com>



扫描二维码，了解更多产品信息
Scan the QR CODE to get more info

CHAIN SAW FILES
& ACCESSORIES

HEBEI SHARKY FILES AND TOOLS CO., LTD

河北小鲨工具有限公司

SINCE 1970'S

Premium Round Chain Saw Files

SHARKY® chain saw files are made from premium quality high carbon steel with a good hardness above 62 HRC. The fine hardness, exact shaping and good tooth spacing will give you a maximum cutting performance when sharpening your saw chain. This will save your labor time and creates a better cutting edge, chain plate angle and finish on the saw chain. High-quality SHARKY® round files are also packaged into our Assembled File Guides and Sharpening Kits to meet the need of most chainsaw users.

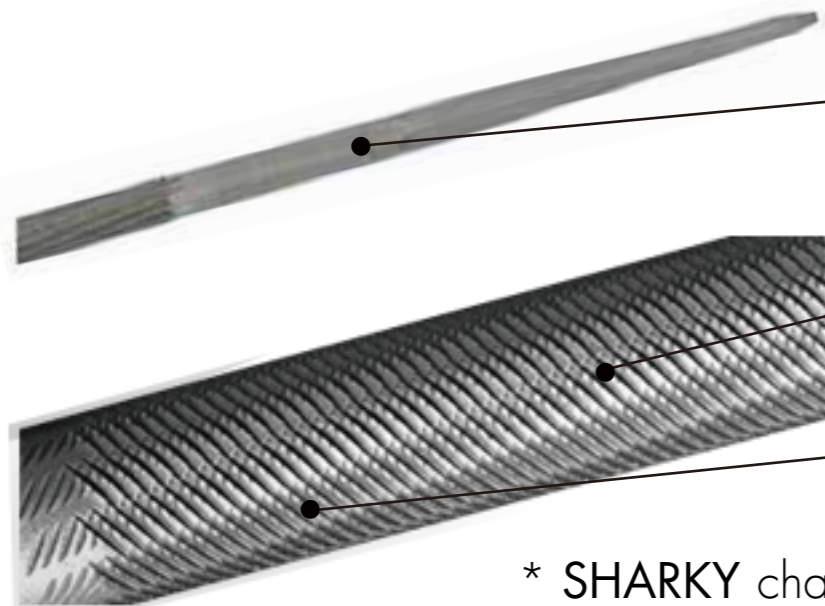

European style, design and shape, 6" round chain saw file has a straight tang.

Hard and sharp tooth, good spacing of tooth saves your labor time, and keep your saw chains a perfect edge. Long lasting file teeth saves your money and makes the work easier.

SHARKY have full range of the file size to fit every saw chain in the world. We also can rebuild the machine to produce the size you will need in any time

* SHARKY chain saw files easily bite deep grooves on the 60HRC hardness tester.



SHARKY European style round chain saw files, with a sharp spirat cut, are especially designed for sharpening round hooded and semi-chisel chain saw teeth. They maintain proper shape in saw teeth and give them a completely smooth, scratch-free finish which produces a sharper, longer lasting cutting edge.



Item No	Length	Diameter		Chain Pitch	Quantity (pcs)	Dimension (cm)	G.W./N.W (Kg)
		mm	inch				
NO.27060	6"	3.2	1/8"	-	1000	43x17x13	10/9
	150mm						
NO.27061	6"	4.0	5/32	1/4"	1000	43x17x13	10/9
	150mm						
NO.27081	8"	4.0	5/32	1/4",0.37"	600	41x27x13	11/10
	200mm						
NO.27082	8"	4.4	11/64	Topic 3/8"	600	41x27x13	12/11
	200mm						
NO.27083	8"	4.8	3/16	0.325"	600	41x27x13	13/12
	200mm						
NO.27084	8"	5.16	13/64	3/8"	600	41x27x13	15/14
	200mm						
NO.27085	8"	5.5	7/32	3/8",.404-7/16"	600	41x27x13	18/17
	200mm						
NO.27086	8"	6.3	1/4	1/2"	600	40x33x13	15/14
	200mm						
NO.27087	8"	7.9	5/16	3/4"	600	40x33x13	21/20
	200mm						

- European style round chainsaw file.
- 20 cuts per CM for standard cut, which offers fastest removal rate per stroke. This is the most widely preferred SHARKY CHAIN SAW FILE.
- We can also make the right teeth for your own chainsaws.
- Round shape, spiral cut, more aggressive on the sharpening of chainsaw teeth.
- Tighten tension on chain to firmly support cutters when filing.
- Filing from inside to outside when sharpen the chainsaw teeth.

- Place file against bevelled cutting surface of teeth 20° to 45° with saw
- Follow saw manufacturers' specifications, and we also can rebuild our machine to meet your requirement.
- Sharpen all left hand cutters on one side of chain.
- Then move to the other side and file all the right hand cutters.
- Check depth gauge height every 2 or 3 sharpenings.
- Height between cutting teeth and depth gauge is between .020" to .030".



电镀金刚石链锯锉

**Diamond Coated Chain Saw Files /
DIAMANTFEILEN KETTENSÄGEFEILE /
LIME DIAMANTÉE SCIES À CHAÎNE /
LIMAS DIAMANTE PARA MOTOSIERRA /
Напильник алмазные круглый ДТФ**

Sharky pure diamond coated chain saw files to sharpen saw chain teeth effortlessly. Never gets blunt, make the files great longer life than normal file. Do not worries with the diamond chainsaw file as it will always stay sharp. Easily bites the steel, making light work of sharpening your saw chain, saving valuable time.

* Size available for 4.0mm(5/32"), 4.8mm(3/16"),5.5mm(7/32").
Or other diameter sizes for customers' requirments.

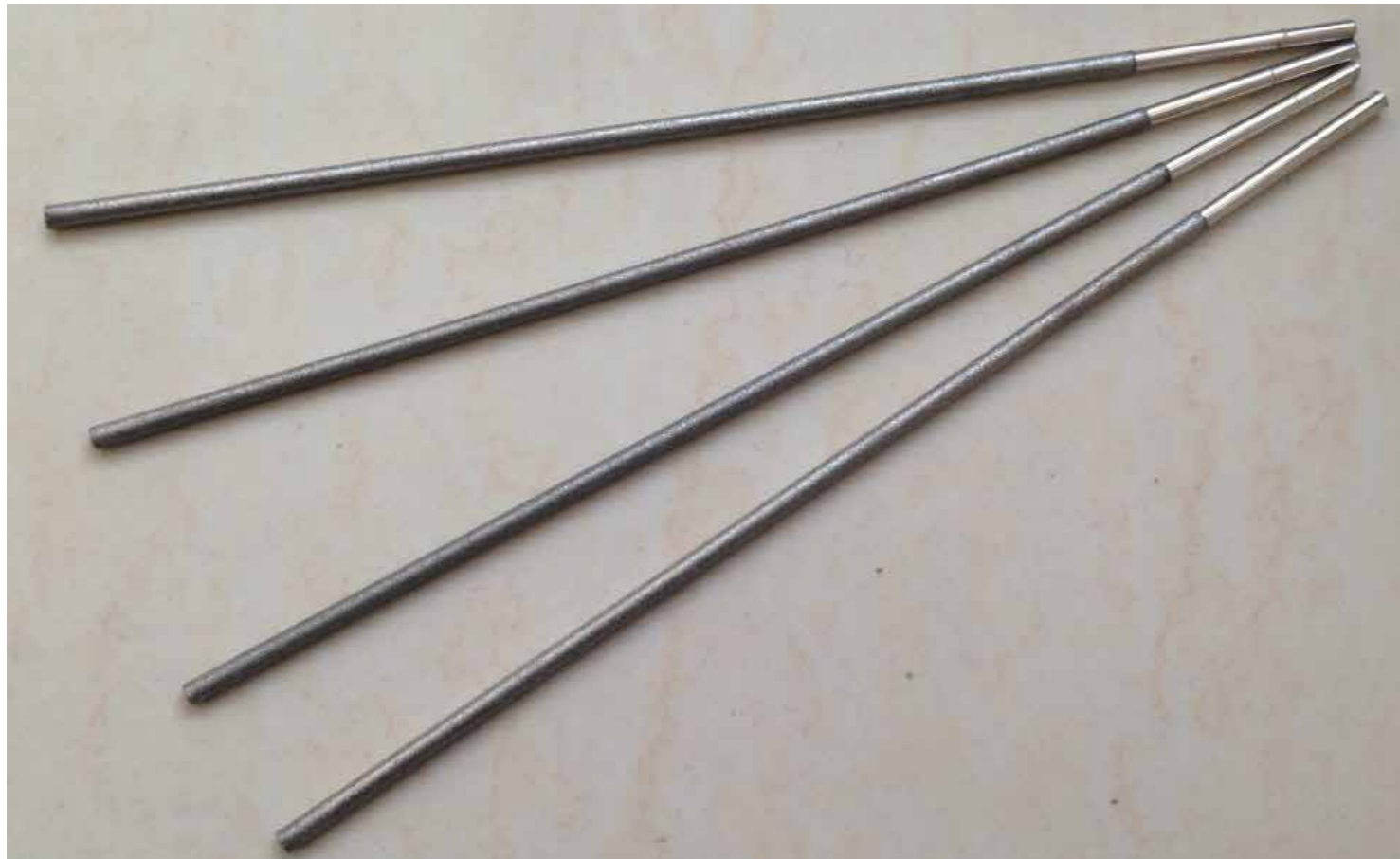

NEW



***Diamond Rotary Chain saw Sharpening Files.**

Size available for 4.0mm(5/32"), 4.8mm(3/16"),5.5mm(7/32").

Or other diameter sizes for customers' requirments.





链锯锉—扁锉单纹
**Flat Chain Saw Files /
 FLACHE KETTENSÄGEFEILE /
 PLATE P. SCIÉS À CHAÎNE /
 PLANA P. MOTOSIERRA /
 Напильник круглый ДТП
 для заточки цепей бензопил**

1. Usage: 6" flat chain saw file lowers the saw chain depth gauges or rakers. Filing down these rakers ensures the cutting teeth plunge to the optimum depth for the ideal wood chip size.

For filing of depth gauges on saw chains and sharpening brush cutter blades

2. Size: blade length:150mm(6 inches). Parallel flat file with round uncut edges, single cut teeth for well finish.

3. Packing: Sharky Flat Chain Saw Files can be ordered by different kind of handles and packing.

* Except for adjusting the depth gauge in the saw chain cutter, flat chain saw files also can help you to maintain the saw bar, sharpen the brush cutter blades, or other cutting tools such as machetes, axes, mower blades, etc.



* Flat chain saw files bulk packing

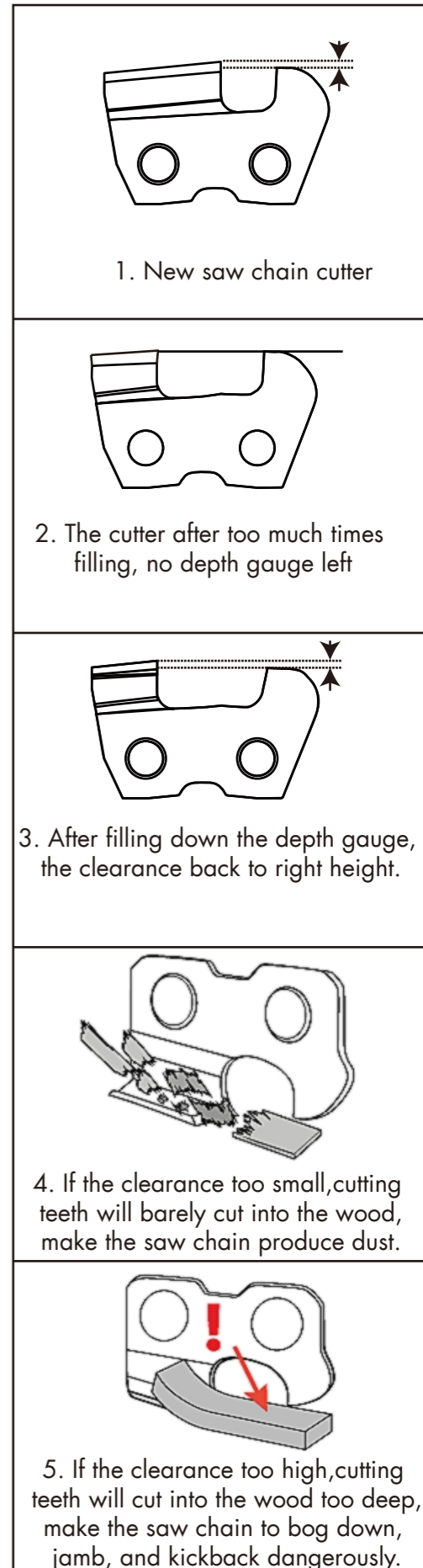
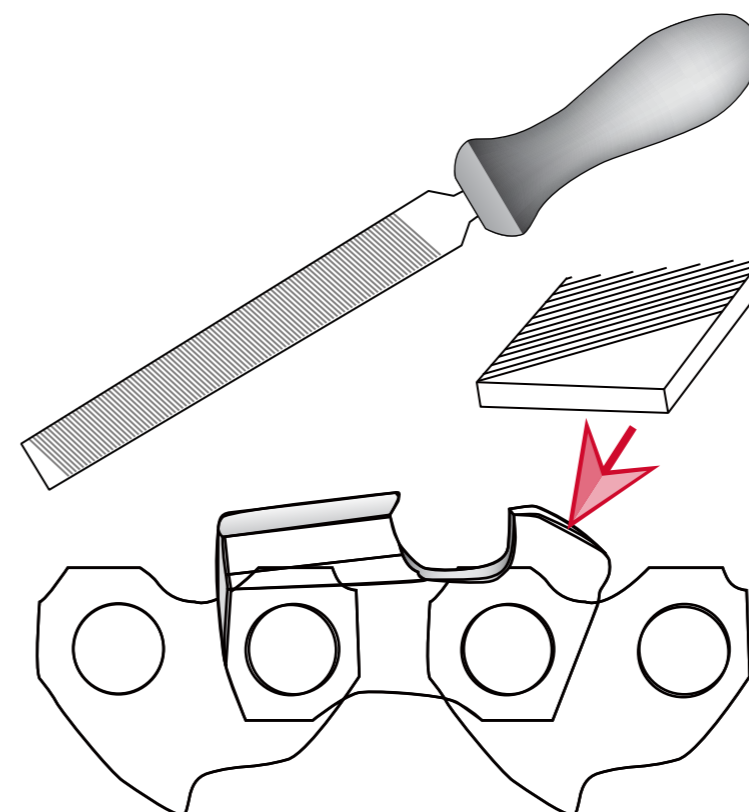

Chain Saw Files Packages



- TYPE A & B: 3PCS PVC sleeve
- TYPE C: Paper inner box, 6 pcs file set
- TYPE D: PVC sleeve + paper inner box, 12 pcs file set
- TYPE E: Paper interlining + paper inner, 12 pcs file set.
- TYPE F: Plastic box, 12 pcs file set.
- All the package can be designed as you like and printing with your artwork.

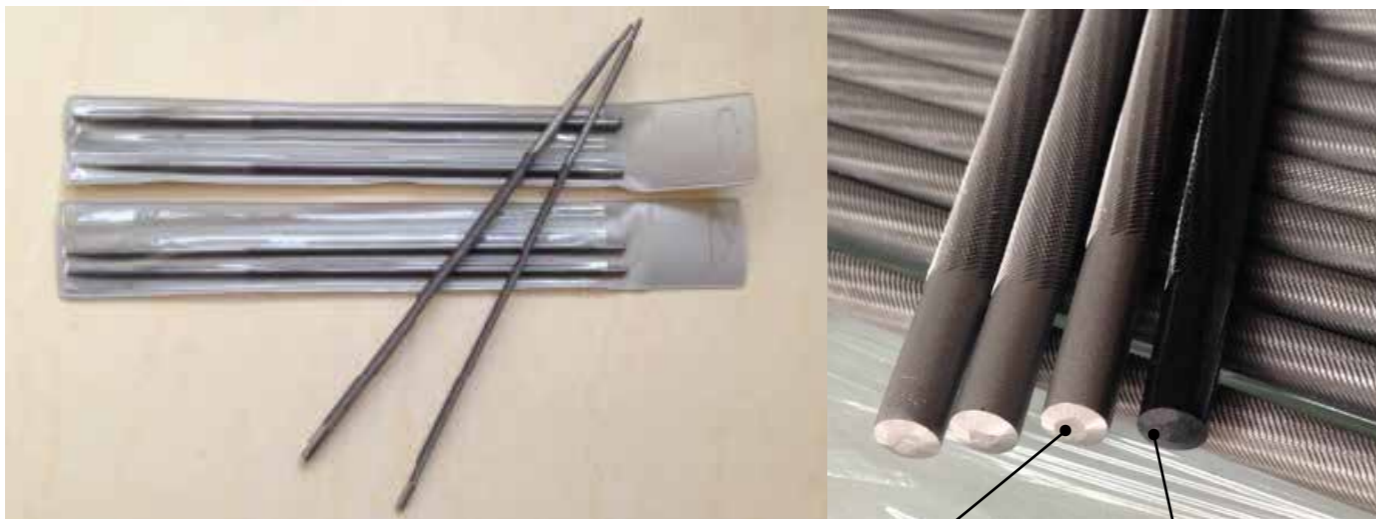

White finish Black finish

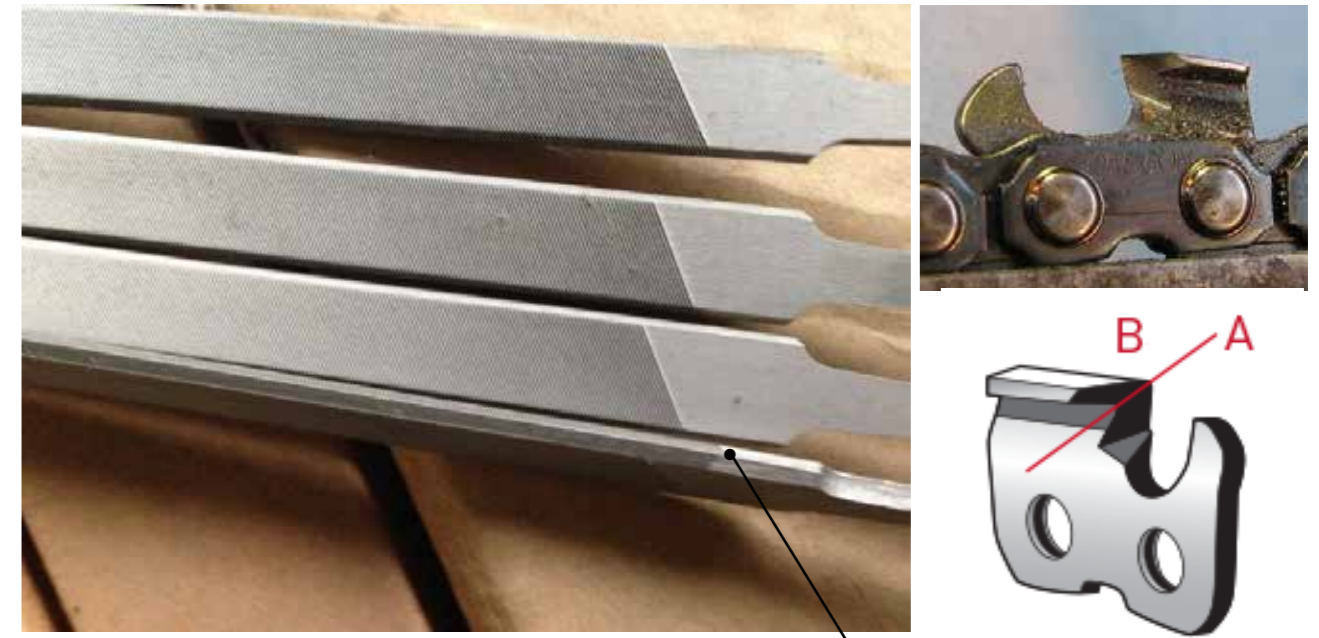

Square edge design,
single cut teeth



- 7" flat chisel bit file, Parallel with edges and sides single cut. For sharpening square chisel chain.

CHAINSAW FILE GUIDE

- Sharky-chainsaw file guide makes the sharpening work with the fixed angle and strength.
- Before the sharpening, make sure the file is tight in the guide groove.
- Usually, the guide will be use with a replacement handle.

*File size and sharpening angle marked on the guide body



ZM-FGD01--- Chain saw file guide with steel hook fastener



ZM-FGD02--- Chain saw file guide with screw fastener

CHAINSAW FILE HANDLE



- We have many other handles patterns for your choice, for more information pls visit our website.
- All the plastic handles can be any color as you like, and we can also develop the mold for your new pattern handles.

SAW CHAIN CUTTER STRUCTURE

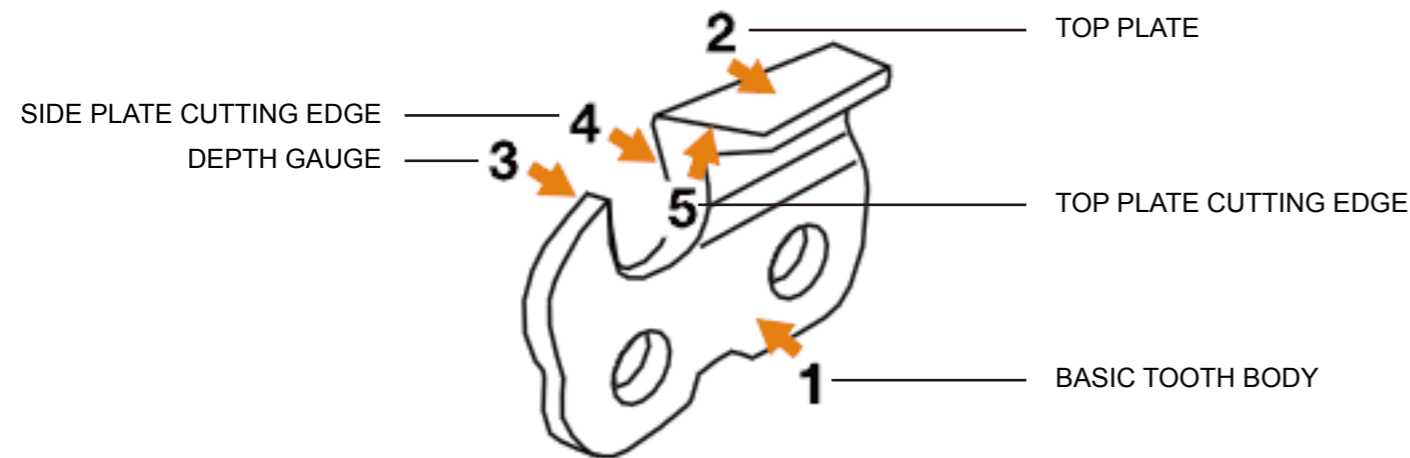

- Saw Chain Cutters: Each cutter has the cutting edge itself and the ramp in front of the cutting edge, called the depth gauge, which leads the cutter into the wood and determines how large a “bite” the cutter will take. If the depth gauge is too high, the chain will cut very slowly; if the depth gauge is too low, the cutter will grab too much wood and jam, perhaps causing kickback. On saw chains, cutters are positioned so that each right-hand cutter alternates with a left-hand cutter.

CHAINSAW FILE DIAMETER GUIDE

CARLTON CHAIN TYPE	PITCH		FILE SIZE	
	INCH	MM	INCH	MM
A1EP, EP-BL, EP-GL	3/8	9.32	7/32	5.5
A1LM, LM-BL, LM-GL	3/8	9.32	7/32	5.5
A1S, S-BL	3/8	9.32	7/32	5.5
A2EP, EP-BL, EP-GL	3/8	9.32	7/32	5.5
A2LM, LM-BL, LM-GL	3/8	9.32	7/32	5.5
A2S, S-BL	3/8	9.32	7/32	5.5
A3EP, EP-BL, EP-GL	3/8	9.32	7/32	5.5
A3LM, LM-BL, LM-GL	3/8	9.32	7/32	5.5
A3S, S-BL	3/8	9.32	7/32	5.5
B2EP, H, LM, S	0.404	10.26	7/32	5.5
B3EP, H, LM, M, S	0.404	10.26	7/32	5.5
B3HR-RP	0.404	10.26	7/32	5.5
B5M	0.404	10.26	7/32	5.5
G7S	3/4	19.05	5/16	8.0
K1C, C-BL	0.325	8.25	3/16	4.8
K1L, L-BL	0.325	8.25	11/64	4.5
K2C, C-BL	0.325	8.25	3/16	4.8
K2L, L-BL	0.325	8.25	11/64	4.5
K3C, C-BL	0.325	8.25	3/16	4.8
K3L, L-BL	0.325	8.25	11/64	4.5
N1C, C-BL	3/8lp	8.25	5/32	4.0
N4C, C-BL	3/8lp	8.25	5/32	4.0

SABRE CHAIN TYPE	PITCH		FILE SIZE	
	INCH	MM	INCH	MM
16	1/4	6.35	5/32	4.0
357, 357D	3/8lp	9.32	5/32	4.0
463	0.404	10.26	1/4	6.3
520(D), 523(D), 528(D)	0.325	8.25	3/16	4.8
727(D), 737(D), 747(D)	3/8	9.32	7/32	5.5
757 MK®, 757 MK® Skip	0.404	10.26	7/32	5.5
757(S), 767(S), 777(S), 858, 863	0.404	10.26	1/4	6.3
880(D), 883(D), 888(D)	3/8	9.32	7/32	5.5
920(D), 923, 928(D)	0.325	8.25	3/16	4.8
943, F, P, PF	0.404	10.26	1/4	6.3
980(D), 983(D), 988(D)	3/8	9.32	7/32	5.5
Jungle 58, J58	0.404	10.26	7/32	5.5
Jungle 63, J68	0.404	10.26	7/32	5.5
Jungle Ripping, E63	0.404	10.26	7/32	5.5
MK II, MK II Skip	0.404	10.26	7/32	5.5

WINDSOR Chain Type	PITCH		FILE SIZE	
	INCH	MM	INCH	MM
50A, AG, AL, ALG	3/8	9.32	7/32	5.5
50J, 50JG, 50JL	0.325	8.25	3/16	4.8
50K	1/4	6.35	5/32	4.0
50R, 50RG	3/8	9.32	5/32	4.0
58A, AG, AL, ALG	3/8	9.32	7/32	5.5
58B	0.404	10.26	7/32	5.5
58J, 58 JL	0.325	8.25	3/16	4.8
63A, AG, AL, ALG	3/8	9.32	7/32	5.5
63B, 63BR	0.404	10.26	7/32	5.5
63J, 63JL	0.325	8.25	11/64	4.5

OREGON CHAIN TYPE	PITCH		FILE SIZE	
	INCH	MM	INCH	MM
9, 10AC	1/2	12.70	1/4	6.3
11BC	3/4	19.05	5/16	8.0
16H, HJ, HK	0.404	10.26	7/32	5.5
18H	0.404	10.26	7/32	5.5
20, 21, 22BP, JP, LP, VB	0.325	8.25	3/16	4.8
25AP	1/4	6.35	5/32	4.0
26, 27R, RA	0.404	10.26	7/32	5.5
26, 27, 27A, 28	0.404	10.26	7/32	5.5
33, 34, 35LG, SL	0.325	8.25	11/64	4.5
50, 51, 52L, LP	0.404	10.26	7/32	5.5
50, 51, 52AJ, AL, 52AK	0.404	10.26	7/32	5.5
57, 58, 59CP, JG, LG	0.404	10.26	7/32	5.5
59AA	0.404	10.26	7/32	5.5
72, 73, 75AP, DP, JG, JP, LG, LP	3/8	9.32	7/32	5.5
72, 73, 75DG, DJ, JL, L, SG	3/8	9.32	3/16	4.8
72, 73, 75AJ, AK, AL, CJ, CK, CL	3/8	9.32	7/32	5.5
76, 77, 78LG, SL	3/8	9.32	11/64	4.5
90JG, SG	3/8	9.32	11/64	4.5
91S, SG, VG, VS	3/8	9.32	5/32	4.0
95R, VP	0.325	6.35	3/16	4.8

STIHL Chain Type	PITCH		FILE SIZE	
	INCH	MM	INCH	MM
Rapid-Standard	1/4	6.35	9/64	3.5
Rapid-Micro	1/4	6.35	9/64	3.5
Rapid-Micro	0.325	8.25	3/16	4.8
Rapid-Super	0.325	8.25	3/16	4.8
Rapid-Standard	3/8	9.32	13/64	5.16
Rapid-Micro	3/8	9.32	13/64	5.16
Rapid-Super	3/8	9.32	13/64	5.16
Topic-Super	3/8	9.32	13/64	5.16
Picco-Micro	1/4	6.35	5/32	4.0
Picco-Micro	3/8	9.32	5/32	4.0
Picco-Micro Narrow	3/8	9.32	5/32	4.0
Picco-Standard	3/8	9.32	9/64	3.5
Rapid-Standard	0.404	10.26	7/32	5.5
Rapid-Micro	0.404	10.26	7/32	5.5
Rapid-Super	0.404	10.26	7/32	5.5
Rapid-Standard	1/2	12.70	1/4	6.3

JONSERED Chain Type	PITCH		FILE SIZE	
	INCH	MM	INCH	MM
504574356	3/8	9.32	7/32	5.5
504574360	3/8	9.32	7/32	5.5
504574368	3/8	9.32	7/32	5.5
504574372	3/8	9.32	7/32	5.5
504575056	0.325	8.25	3/16	4.8
504575064	0.325	8.25	3/16	4.8
504575072	0.325	8.25	3/16	4.8
504578145	3/8	9.32	5/32	4.0
504578150	3/8	9.32	5/32	4.0
504579564	1/4	6.35	5/32	4.0
504579572	1/4	6.35	5/32	4.0